



특징 (Character)

- 링크레버 구동방식의 각도개폐형 제품
Angular type by link lever driving unit
- AF24-12N, 16N의 개발로 전 모델 마그네틱 센서 부착가능
Magnetic sensor is available for all types by developing AF24-12N, 16N
- 각형 BODY형태로 3방향 취부가능
Mounting possible from 3 sides by square type body
- 개폐검출 센서 전기종 부착가능
Magnetic sensor is available for open-close sensing Kinetics



링크레버 방식 (Link lever type)

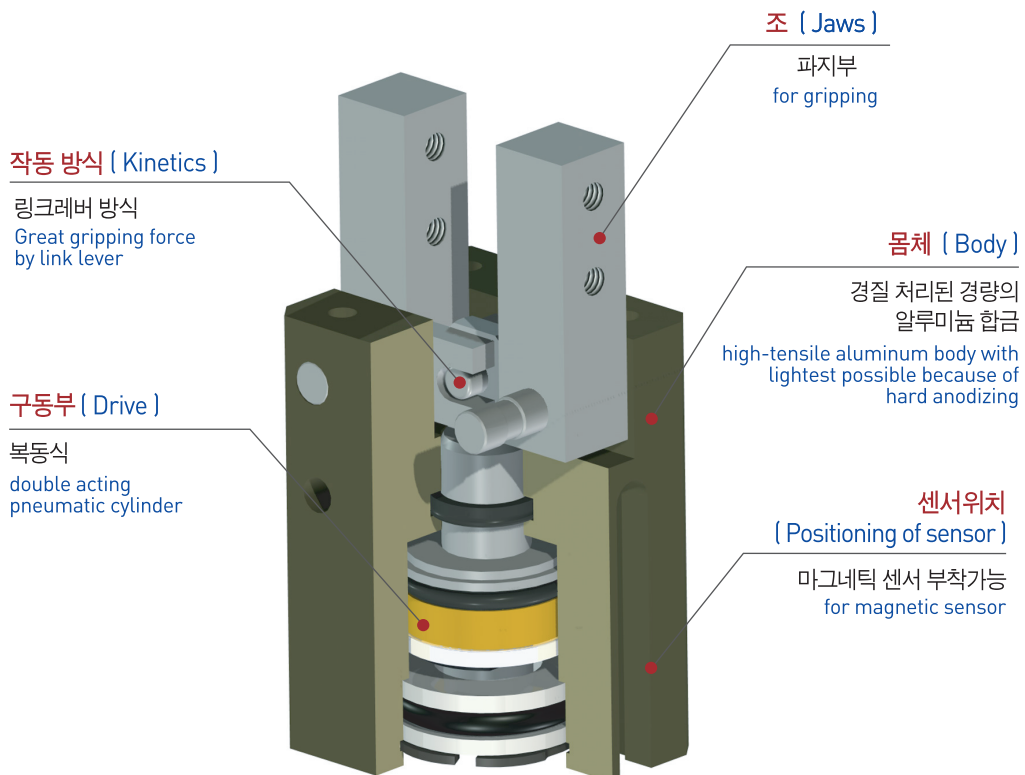

부품분해도 (Exploded view)

※ 본 분해도는 한 제품을 예시하였으므로 기종별로 차이가 있을 수 있습니다
 ※ This is exploded view illustrates a certain product only. The contents may vary by product models.

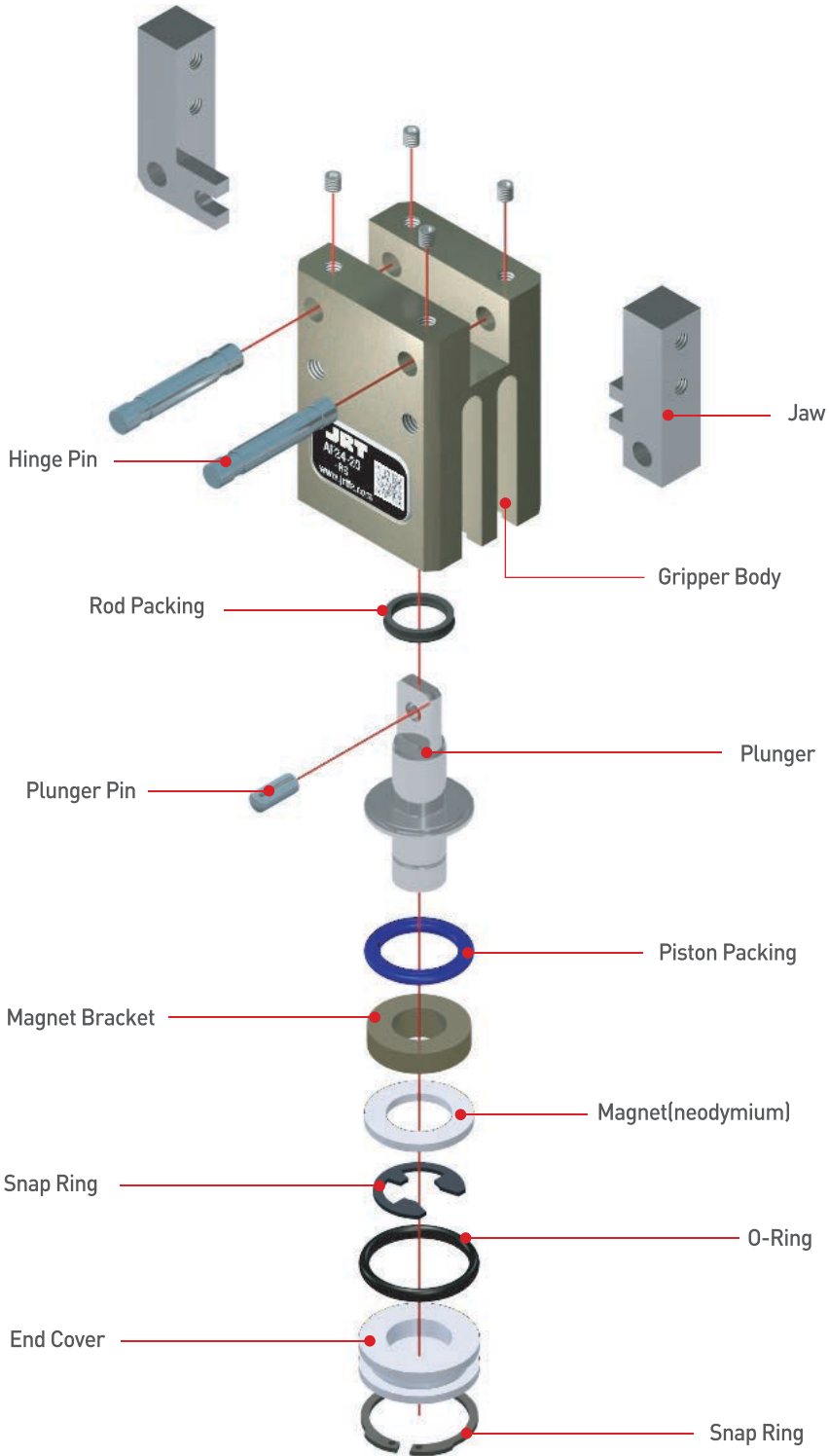

AF101
AF02
AF03
AF04P
AF105P
AF06
AF10
AF13
AF13C
AF14
AF15
AF316
AF17
AF117
AF19
AF24
AF26
AF28D
AF30
AF30L
AF30SP
AF40
AF46
AF56N
RAF56N
MF16

주문기호 (Ordering Code)

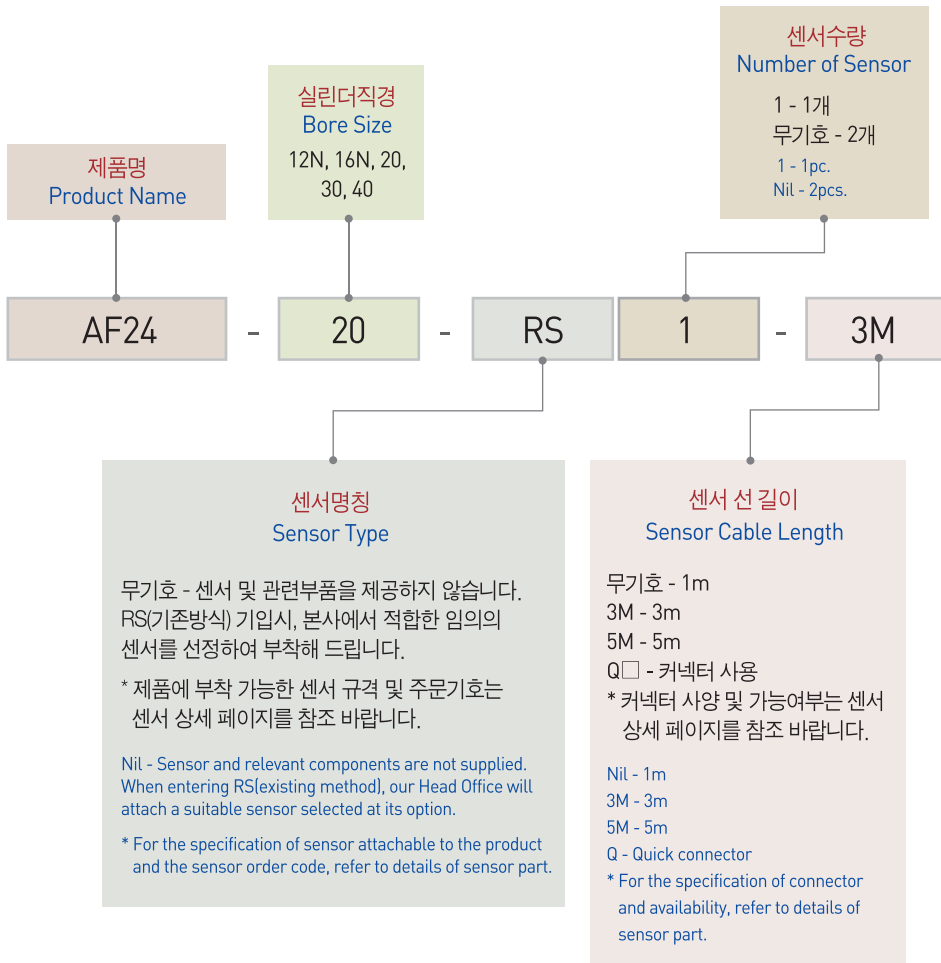

☐ 제품사양 (Specification)

P=공기압력(bar) , L=작용점까지의 거리(mm)
P=Air Pressure(bar) , L=Exertion length(mm)

제품명칭 Products Name	AF24-12N	AF24-16N	AF24-20	AF24-30	AF24-40	단위 Unit
개폐범위 Stroke	-5 to 15	-5 to 15	-5 to 20	-5 to 20	-5 to 25	degree
제품중량 Weight	0.05	0.06	0.2	0.41	0.76	kg
최대치구길이 Max. length attach	45	60	70	85	120	mm
배관접속구 Fitting size	M5	M5	M5	PF(G) 1/8	PF(G) 1/8	
파지력 : 열림시 Gripping force : Open	9.81P/0.1L	19.62P/0.1L	36.3P/0.1L	110.85P/0.1L	234.46P/0.1L	N
파지력 : 닫힘시 Gripping force : Close	7.36P/0.1L	14.72P/0.1L	27.47P/0.1L	86.33P/0.1L	191.3P/0.1L	N
1사이클당 공기소모량 Air consumption per cycle	0.3	0.7	1.6	4.7	11.0	cm ³
닫힘시/열림시 시간 Closing / Opening time	0.01/0.01	0.01/0.01	0.01/0.01	0.01/0.01	0.01/0.01	sec
반복정밀도 Repeat accuracy	0.03	0.03	0.03	0.03	0.03	mm
연속사용회수 Continuation usage amount	60	60	60	45	40	cpm
사용압력 Operating pressure	3~7					bar
주위온도 Ambient temperature	-5 to 60					℃
윤활 Lubrication	불필요 Needless					

반복정밀도 : 연속 100회 작동후 측정치
After 100 consecutive strokes to end positions

- AF101
- AF02
- AF03
- AF04P
- AF105P
- AF06
- AF10
- AF13
- AF13C
- AF14
- AF15
- AF316
- AF17
- AF117
- AF19
- AF24**
- AF26
- AF28D
- AF30
- AF30L
- AF30SP
- AF40
- AF46
- AF56N
- RAF56N
- MF16

☐ NOTE

▣ 작용점에서의 파지력 (Gripping Force From a Point of Action)

범례 (Legend) : — 7[bar] — 5[bar] — 3[bar]

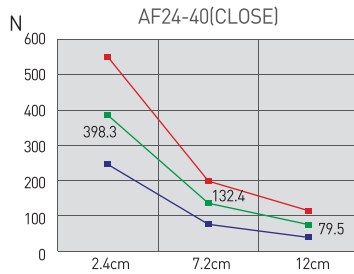
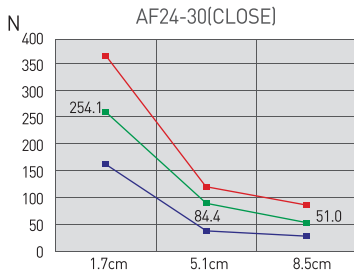
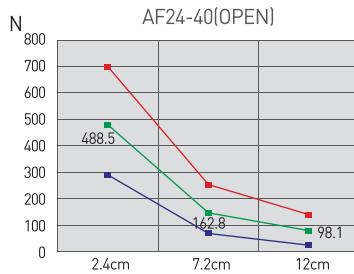
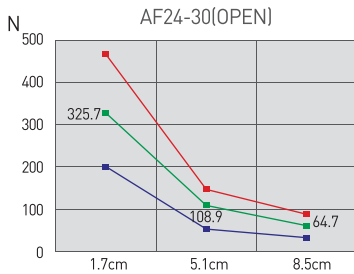
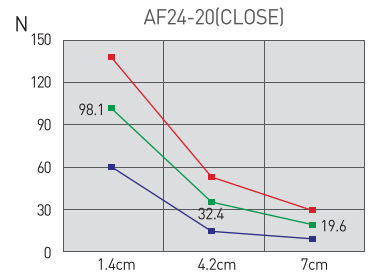
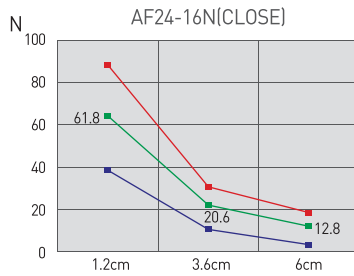
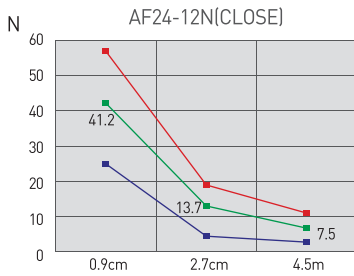
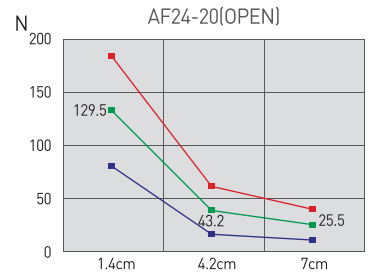
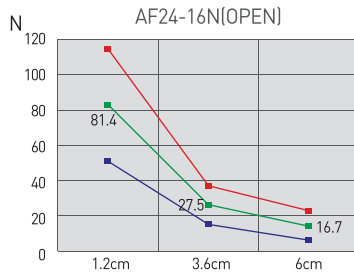
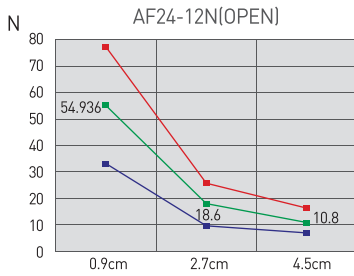

AF24-12N

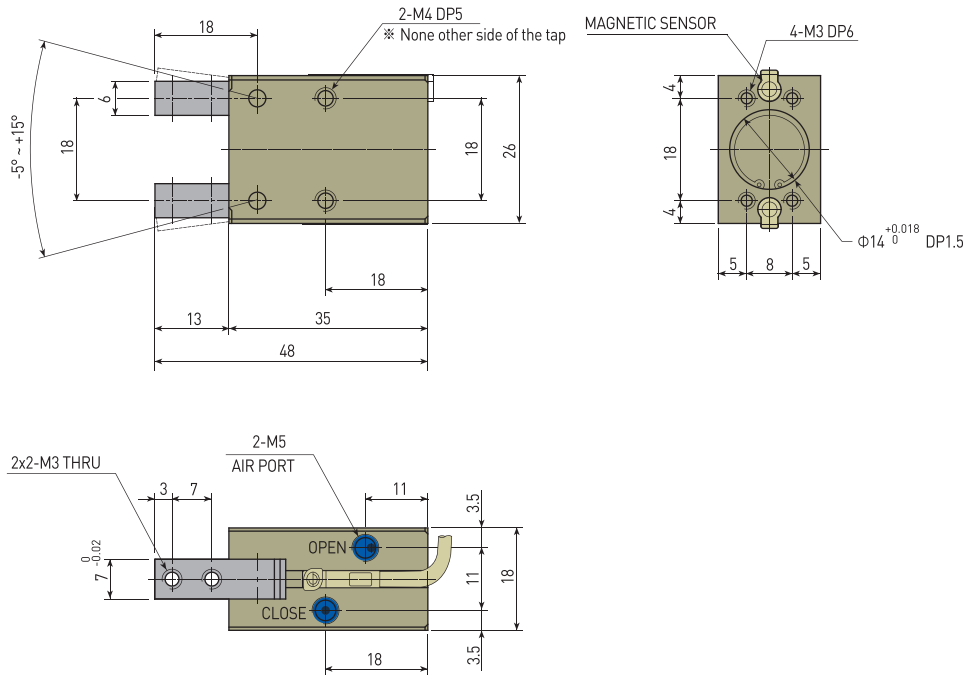

AF24-16N

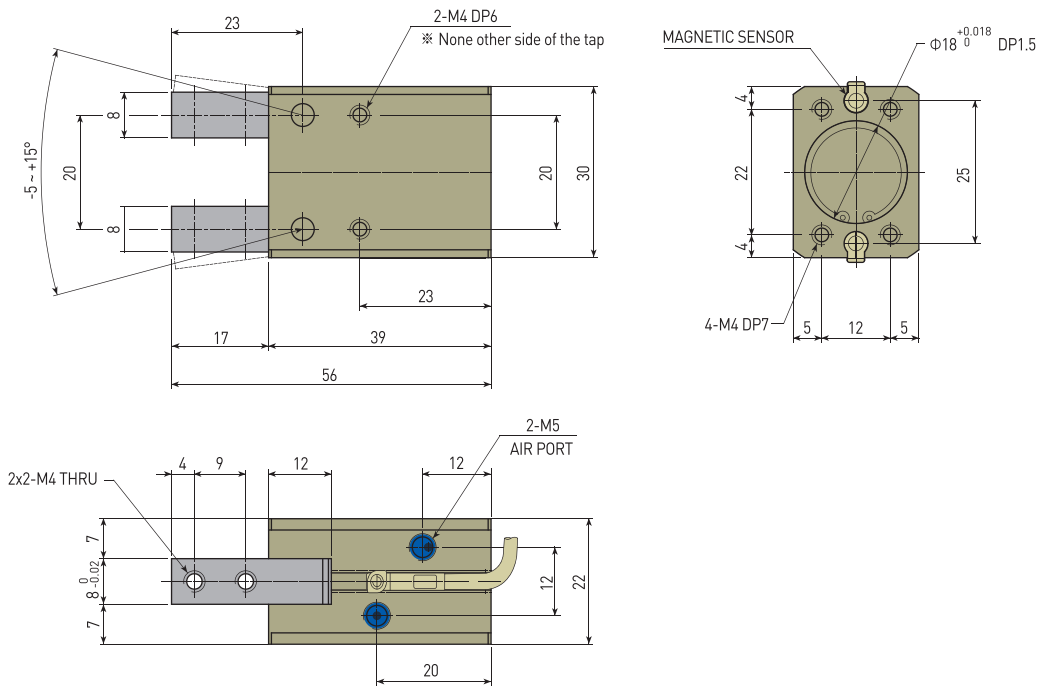

- AF101
- AF02
- AF03
- AF04P
- AF105P
- AF06
- AF10
- AF13
- AF13C
- AF14
- AF15
- AF316
- AF17
- AF117
- AF19
- AF24**
- AF26
- AF28D
- AF30
- AF30L
- AF30SP
- AF40
- AF46
- AF56N
- RAF56N
- MF16

AF24-20

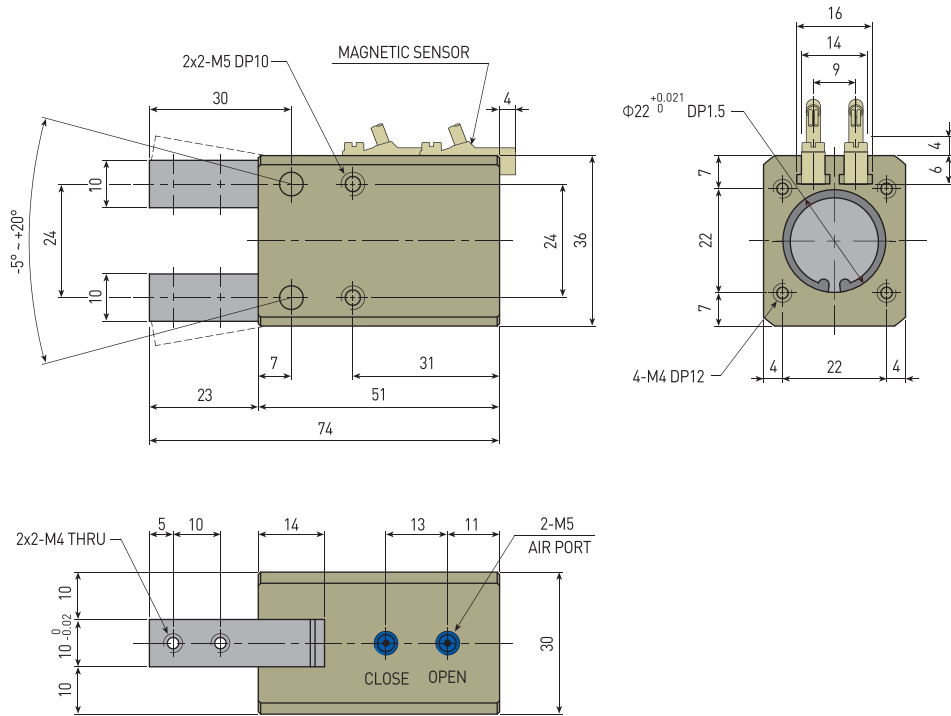

AF24-30

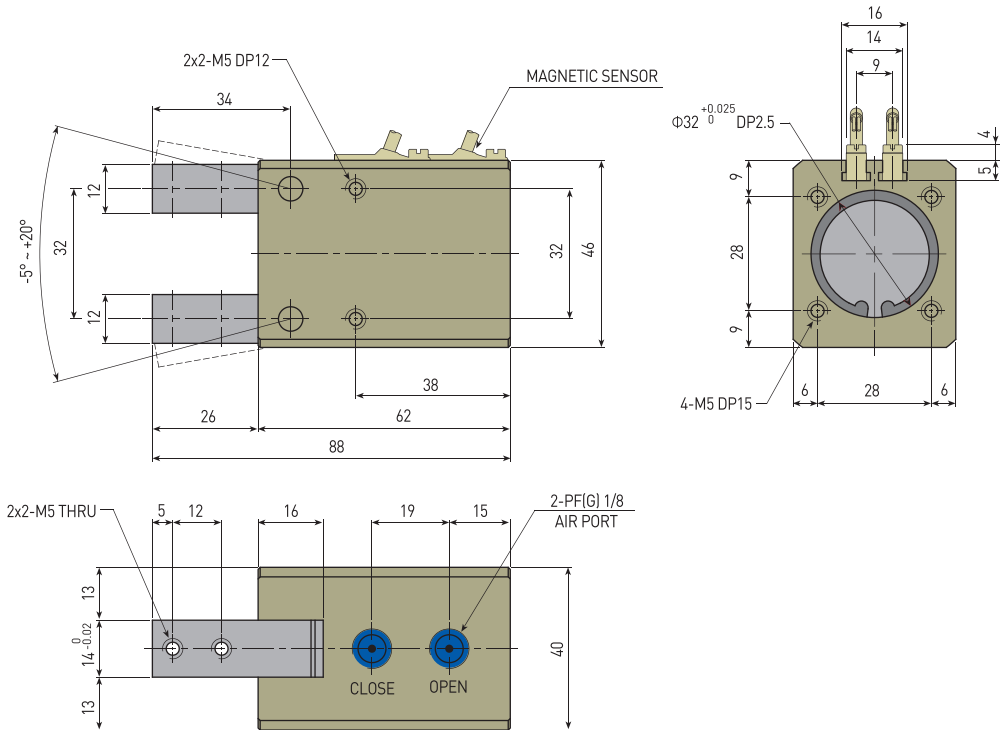

AF24-40

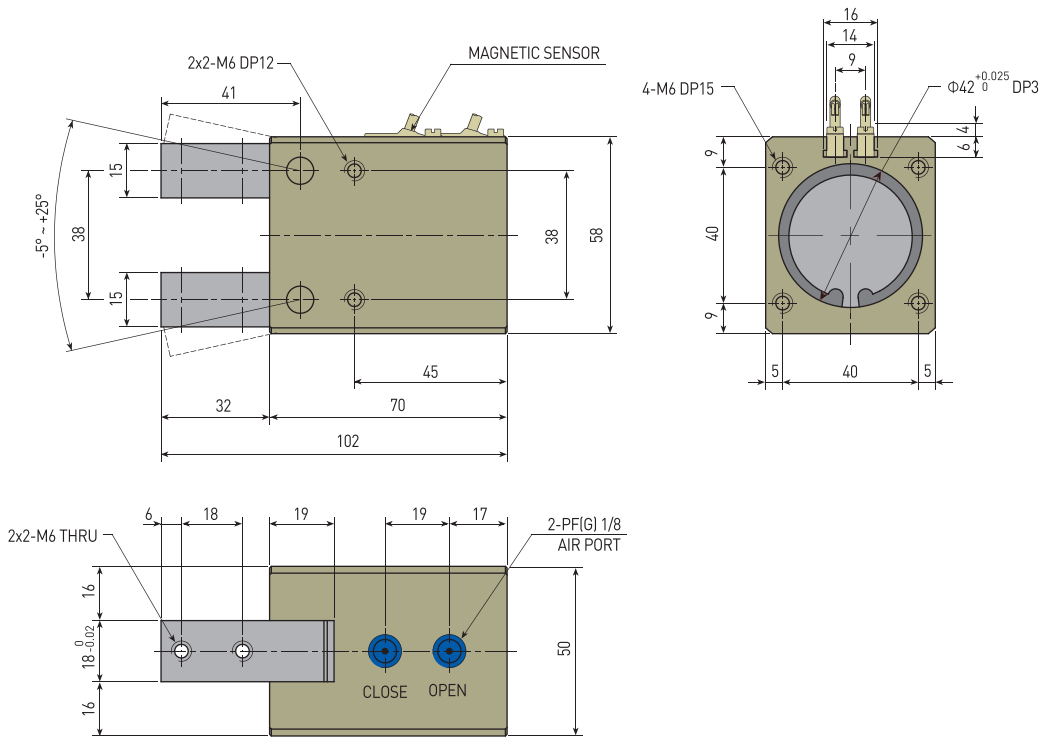

NOTE

- AF101
- AF02
- AF03
- AF04P
- AF105P
- AF06
- AF10
- AF13
- AF13C
- AF14
- AF15
- AF316
- AF17
- AF117
- AF19
- AF24**
- AF26
- AF28D
- AF30
- AF30L
- AF30SP
- AF40
- AF46
- AF56N
- RAF56N
- MF16